

# THE PARKLANE 185 | NORTH QLD



**FreshHomes**  
BUILT NEW JUST FOR YOU

HOUSE ONLY  
PRICE FROM

**\$298,900**

4

2

2

Living Area	133.22m <sup>2</sup>
Garage Area	36.26m <sup>2</sup>
Alfresco Area	12.8m <sup>2</sup>
Porch Area	4.22m <sup>2</sup>
<b>Total Area</b>	<b>185.88m<sup>2</sup></b>

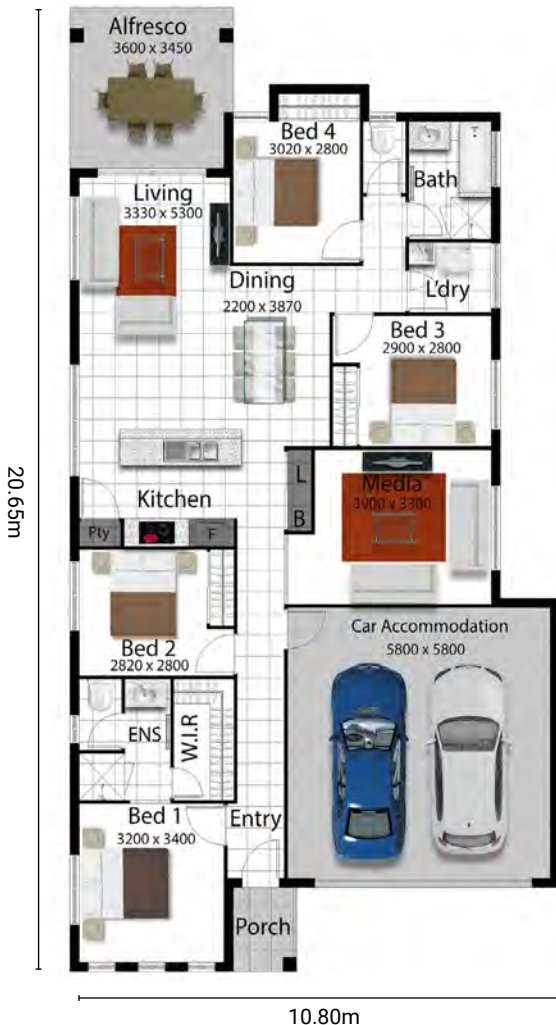

## PACKAGE INCLUDES:

- 25 Years structural guarantee\*
- Feature entry door
- Colorbond roof, gutters and fascia
- Air-conditioning throughout
- Security screens/key locks to windows
- Superior tiles and quality carpet
- Custom made kitchen by MODULINE
- Stunning stone bench tops to kitchen
- TECHNIKA cooking appliances with 5 years warranty
- Tiled niche to ensuite and bathroom
- Polished edge mirrors to ensuite and bathroom
- Soft close vanity cupboards
- Three Point termite protection
- Colorbond roof, gutters & fascia
- Key locks to windows
- Tiles to porch
- Magnetic door catches
- Ventilated eaves for cooler home
- R2.5 Ceiling insulation
- LED lighting
- NBN connection
- SOLAR ready
- Double remote controlled garage
- Wall mount clothesline
- Rendered letterbox
- Stone aggregate driveway
- Upgrade facade not included



**FreshHomes**  
BUILT NEW JUST FOR YOU

Brisbane | Ipswich | Gold Coast | Sunshine Coast | Townsville

[freshhomes.com.au](http://freshhomes.com.au)

Plan and images are for illustration only. All elevations are masonry block with painted architectural textured coating. Brick finishes apply to SEQ only. Floor plan and elevation as shown in this brochure are artists impressions only and do not form any part of the contract to build. Standard plans and specifications take precedence over any design, elevation or brochure. These designs are exclusively the property of Fresh Homes and as such as copyright. QBCC1088603. Prices may change without notice. \*Applies to building structure only.