

THE MAYFAIR 222 | NORTH QLD



FreshHomes
BUILT NEW JUST FOR YOU

HOUSE ONLY
PRICE FROM

\$357,329

4

2

2

Living Area	167.1m ²
Garage Area	35.6m ²
Alfresco Area	15.0m ²
Porch Area	4.5m ²
Total Area	222.2m²

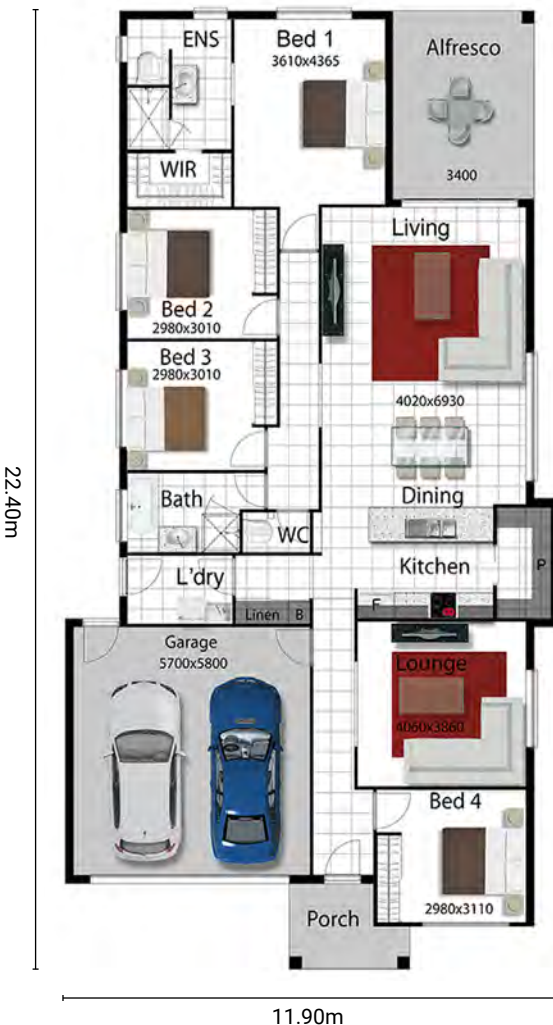

PACKAGE INCLUDES:

- 25 Years structural guarantee*
- Persona specification
- Split system air-conditioning throughout
- 1.2m wide glass feature entry door
- Stunning stone bench tops to kitchen
- Spacious walk-in pantry
- Custom made kitchen by MODULINE
- TECHNIKA cooking appliances with 5 years warranty
- Security screens and key locks to windows
- Quality carpet and tiles throughout
- Tiled alfresco with ceiling fan
- Tiles to porch
- Remote controlled panel lift garage door
- Colorbond roof, gutters and fascia
- Smooth render
- Luxury tapware
- NBN connection
- SOLAR ready
- LED lighting
- C1 wind rating
- Three point termite protection
- M class soil
- Wall mount clothesline
- Rendered letterbox
- Stone aggregate driveway



FreshHomes
BUILT NEW JUST FOR YOU

Brisbane | Ipswich | Gold Coast | Sunshine Coast | Townsville

freshhomes.com.au

Plan and images are for illustration only. All elevations are masonry block with painted architectural textured coating. Brick finishes apply to SEQ only. Floor plan and elevation as shown in this brochure are artists impressions only and do not form any part of the contract to build. Standard plans and specifications take precedence over any design, elevation or brochure. These designs are exclusively the property of Fresh Homes and as such as copyright. QBCC1088603. Prices may change without notice. *Applies to building structure only.