

LOT 470 NEW ROAD 'BELLEVUE' RIPLEY



Fresh Homes
BUILT NEW JUST FOR YOU

**FOR
SALE**

HOUSE AND
LAND PRICE

\$794,000

4 

2 

2 

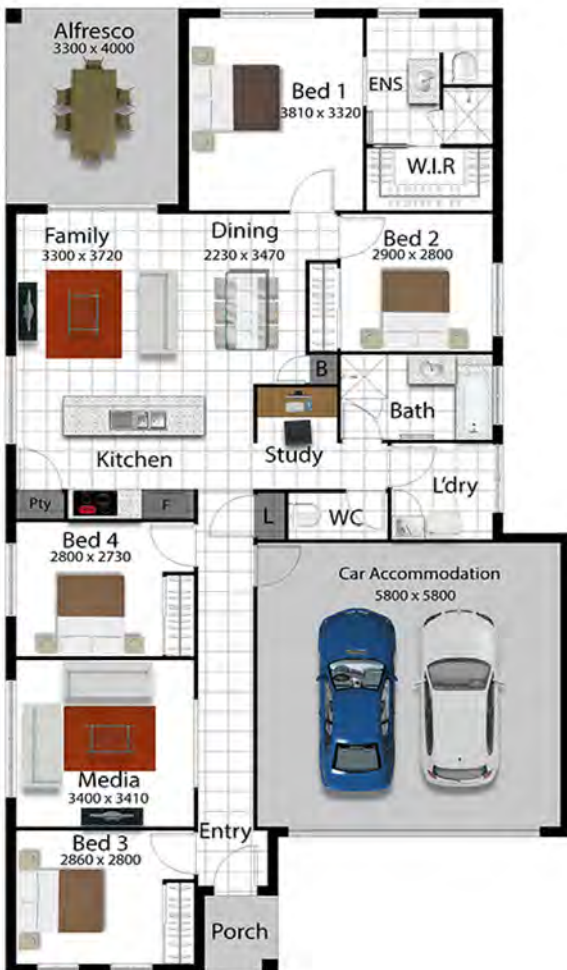

THE MAYFAIR 185

LAND SIZE 495m²

Living Area	132.69m ²
Garage Area	36.86m ²
Alfresco Area	12.96m ²
Porch Area	2.24m ²
Total Area	184.75m²

PACKAGE INCLUDES:

- 25 Year Structural Guarantee*
- 6 Star Energy Rating
- Bathroom and Ensuite
- Builder's Persona Range tiles and carpets
- Exposed Aggregate Driveway
- Smart Stone To Kitchen benchtops
- Colorbond Roof
- 2550mm High Ceilings
- Upgraded Tapware
- Site Cost Allowance

LEE ROEBUCK
PH: 0413 057 335

lee.roebuck@freshhomes.com.au



Fresh Homes
BUILT NEW JUST FOR YOU

Brisbane | Ipswich | Gold Coast | Sunshine Coast | Townsville

freshhomes.com.au

Plan and images are for illustration only. All elevations are masonry block with painted architectural textured coating. Brick finishes apply to SEQ only. Floor plan and elevation as shown in this brochure are artists impressions only and do not form any part of the contract to build. Standard plans and specifications take precedence over any design, elevation or brochure. These designs are exclusively the property of Fresh Homes and as such as copyright. QBCC1088603. Prices may change without notice. *Applies to building structure only.